

front view 455-575

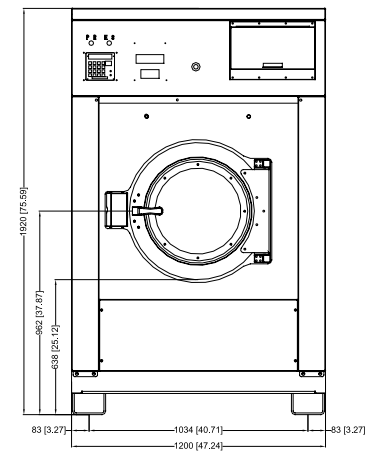
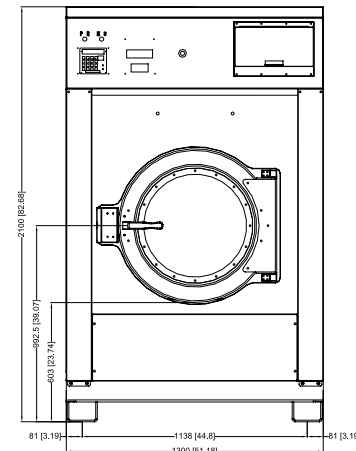

front view 730-900

**HF455 - HF575**

- A. Soft water connection 3/4"
- B. Warm water connection 3/4"
- C. Hard water connection 3/4"
- D. Electrical connection
- E. Electrical connection clamps
- F. Main switch
- G. Ventilation cabinet
- H. Ventilation
- I. Steam connection 1/2"
- J. Drain valve

HF730 - HF900

- A. Soft water connection 3/4"
- B. Soft water connection 1"
- C. Warm water connection 1"
- D. Hard water connection 1"
- E. Electrical connection
- F. Electrical connection clamps
- G. Main switch
- H. Ventilation cabinet
- I. Ventilation
- J. Steam connection 3/4"
- K. Drain valve

rear view 455-575

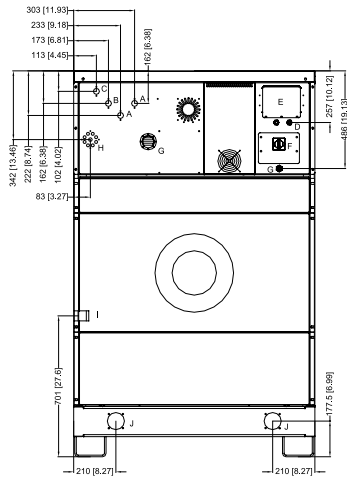

rear view 730-900

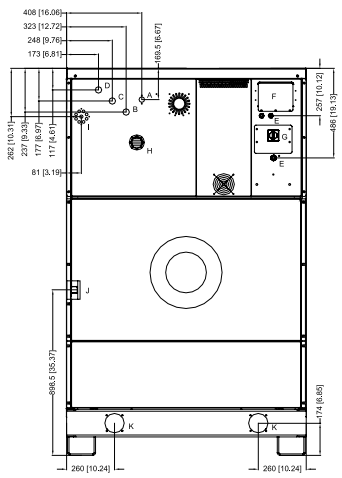

side view 455

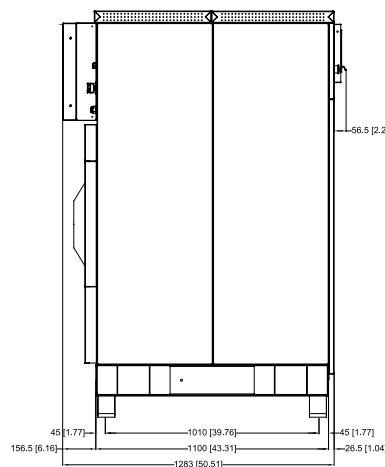

side view 730

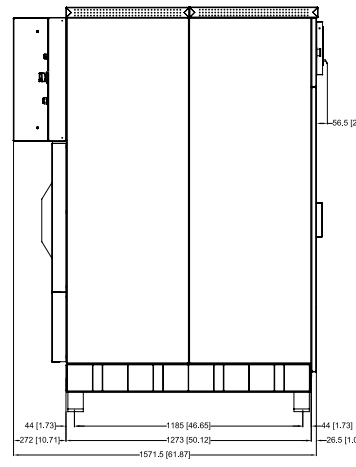

side view 575

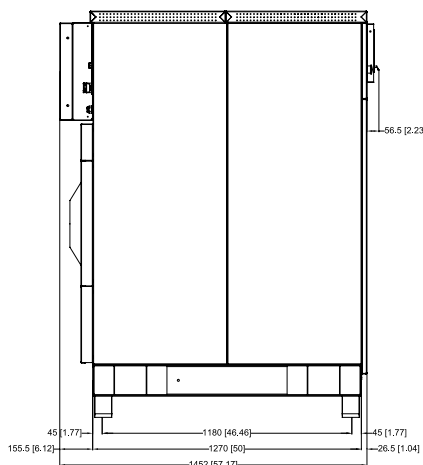

side view 900

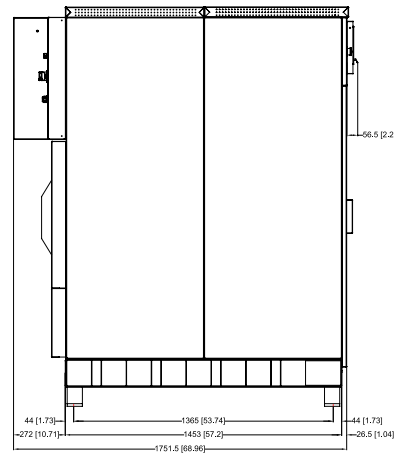
**TECHNICAL SPECIFICATIONS HF 455-575-730-900**

	HF 455	HF 575	HF 730	HF 900				
Cylinder:	Capacity 1/9 (kg)	50,5	63,8	81,1				
	Capacity 1/10 (kg)	45,5	57,5	73				
	Volume (L)	455	570	730				
	Diameter (mm)	980	980	1095				
	Depth (mm)	597	775	775				
Perforations diam. (mm)	3	3	3,5	3,5				
Door opening diam. (mm)	500	500	622	622				
Height to doorhandle (mm)	960	960	1020	1020				
Speed:	High spin (rpm)	500 to 800	500 to 800	500 to 750				
	Low spin (rpm)	250 to 400	250 to 400	250 to 400				
	Intermediate spin (rpm)	100	100	80	80			
Wash (rpm)	10 to 50	10 to 50	10 to 50	10 to 50				
G-force	350	350	350	350				
Kinetic energy of the cylinder (N/m)	18361	23257	29581	29581				
Dynamic bottom load (N/13 Hz)	2960	3900	4960	6100				
Power motor (W (tri))	5500	7500	11500	11500				
Water pressure (bar)	3 to 5	3 to 5	3 to 5	3 to 5				
Hot water T° (boiler fed) (°C)	80	80	80	80				
Warm water need (boiler fed machine) (l/cycle)	350	445	566	566				
Heating:	Electrical 230 V (tri) (kW)	27	27	27				
	Electrical 400 V (tri + N) (kW)	27	27	27				
	Electrical 400 V (tri + N) (kW)	36	36	36				
Steam (kg/cycle)	45	57	70	90				
Diam. drain (mm/")	75 /3	75 /3	75/3 (2x)	75/3 (2x)				
Drain by gravity (L/min)	160	160	200	200				
Steam connection (")	1/2	1/2	3/4	3/4				
Steam pressure (bar)	2,0 - 5,5	2,0 - 5,5	2,0 - 5,5	2,0 - 5,5				
Weight:	Nett (kg)	1520	1645	2100				
	Gross (kg)	1697	1822	2350				
Dimensions	Height (mm)	1920	1920	2100				
	Width (mm)	1200	1200	1300				
	Depth (mm)	1335	1500	1620				
	Volume (m³)	3,74	4,26	5,74				
Packing dimensions:	Height (mm)	2010	2010	2300				
	Width (mm)	1300	1300	1450				
	Depth (mm)	1430	1630	1720				
Type of heating	POWER SUPPLY - FUSES							
	230V	400V	230V	400V	230V	400V	230V	400V
Boiler fed	3AC (tri + N)	3AC (tri + N)	3AC (tri + N)	3AC (tri + N)	3AC (tri + N)	3AC (tri + N)	3AC (tri + N)	3AC (tri + N)
Steam heating	20 A	20 A	20 A	20 A	20 A	20 A	20 A	20 A
Electrical heating 27 kW	80 A*	63 A	80 A*	63 A	80 A*	63 A	80 A*	63 A
Electrical heating 36 kW		80 A*		80 A*		80 A*		80 A*

All specifications subject to change without notice

[*] Standard heating



Alliance International bvba, Nieuwstraat 146, B-8560 Wevelgem (Belgium)
Tel +32 56/41 20 54 - Fax +32 56/41 86 74 - info@ipso.be - WWW.IPSO.BE

HIGH SPIN WASHER EXTRACTORS

HF 455
HF 575
HF 730
HF 900





HF 455 · HF 575 · HF 730 · HF 900

Star-shaped bearing housing

- Long life span of the bearings
- Oversized industrial design
- Equal diversion of the vibrations



Hinges

- Extra strong over-dimensioned hinges: long-life span



Door

- Extra large door opening for easy loading and unloading
- Strong ergonomical doorhandle
- 180° opening of the door

New: Tilting

- Easier and faster loading & unloading -> Increased productivity
- Easier for a single person to operate machine
- Optionally available on all models

Drum

- Drum, tub and cabinet in stainless steel
- Performed lifting ribs



Microprocessor PS40

- Freely programmable
- 10 standard programmes
- 40 possible programmes
- Temperature, water level and cycle time freely programmable
- Connection up to 12 pumps for liquid soap
- Control of 2 drain valves (option)
- Infrared port facilitating the downloading of programmes

Standard inverter drive

- Washing and spin speeds: freely programmable
- High G-forces
- Low sound level
- Rotation and stop speed programmes from 0,1 till 60 sec

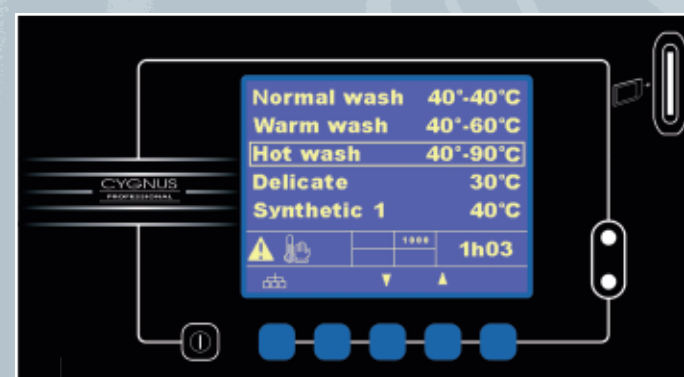

Cygnus Professional

Cygnus Professional allows modification of wash data & parameters at any time, even during the wash cycle.

- Large LCD-display: easily understandable
- Possibility to consult the complete history/logbook of all wash facts on the display
- Extensive help-function: extensive assistance to solve the error

Injection pumps

- Possibility to install up to 12 liquid soap pumps (pumps optional). Connections to install the pumps are standard on PS 40



Sealing

- Automatic lubrication
- Triple sealing for total water tightness

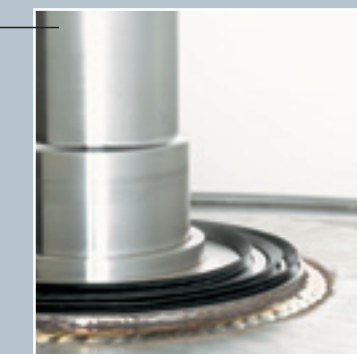

Practical soap dispenser

- Standard front soap dispenser:
- 3 compartments
 - Soap pumps optionally available

Suspension

- Combination of shock absorbers and springs for maximum absorption



Pulleys

- Pulleys in cast iron
- Speed sensor for exact rpm control



Bearing house

- Long life span of the bearings
- Cast iron
- Automatic lubrication